

# 50W 0/1-10V LED Driver(Constant Voltage)

09.2007V.04027



**Important:** Read All Instructions Prior to Installation

## Function introduction

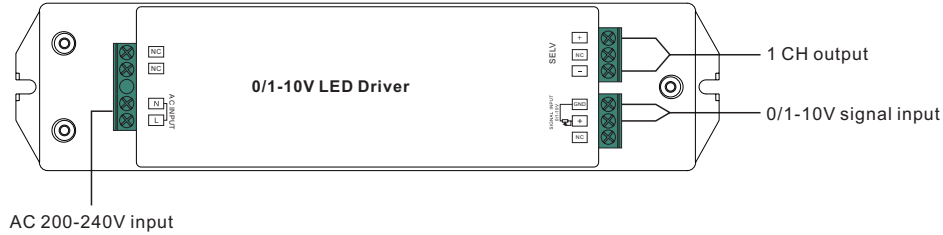

## Product Data

Output	DC Voltage	12V DC	24V DC
	Max. Current	4.16A max.	2.08A max.
	Rated Power	max. 50W	
Input	Voltage Range	200-240V AC	
	Frequency	50/60Hz	
	Power Factor (Typ.)	> 0.9	
	Efficiency (Typ.)	85% @ 230VAC	88% @ 230VAC
	Input Current (Typ.)	0.27A @ 230VAC	
	Inrush Current (Typ.)	COLD START Max. 2A at 230VAC	
Protection	Short Circuit	Yes, auto recovery after fault removed	
	Over Current	Yes, auto recovery after fault removed	
	Over Temperature	Yes, auto recovery after fault removed	
Environment	Working Temp.	-20°C ~ +45°C	
	Max. Case Temp.	85°C	
	Working Humidity	10% ~ 95% RH non-condensing	
	Storage Temp. & Humidity	-40°C ~ +80°C, 10% ~ 95% RH	
Safety&EMC	Safety Standards	ENEC EN61347-1, EN61347-2-13 approved	
	Withstand Voltage	I/P-O/P: 3.75KVAC	

	EMC Emission	EN55015, EN61000-3-2, EN61000-3-3
	EMC Immunity	EN61547, EN61000-4-2,3,4,5,6,8,11, surge immunity Line-Line 1KV
Others	MTBF	193.6K hrs min. @ 230VAC at full load and 25°C ambient temperature
	Dimension	210*50*32mm (L*W*H)

- Dimmable LED driver
- Max. output power 50W
- 1 channel DC 12/24V constant voltage output
- Class II power supply, full isolated plastic case
- High power factor and efficiency
- To switch and dim single color LED lighting
- Built-in 0/1-10V interface
- Compatible with universal 0/1-10V signal
- With 1 channel 0/1-10V signal input, 1 channel PWM output
- 0-100% dimming range via logarithmic characteristic , perfect for human's vision
- IP20 rating
- Suitable for indoor LED lighting applications
- 5 years warranty

## Safety & Warnings

- DO NOT install with power applied to device.
- DO NOT expose the device to moisture.

## Wiring Diagram

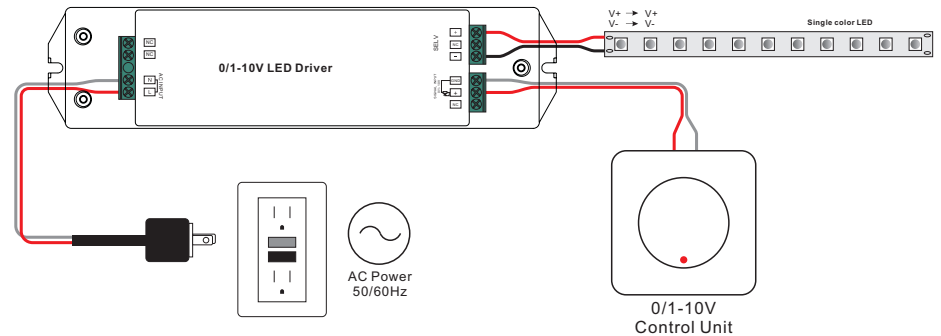

## Product Dimension

