



Technology Partner  
**SILVAIR**

Work with Silvair

# DALI BLE Fixture-integrated Sensorless Controller

## SR-SV9035A-D

### Features

- Bluetooth to DALI signal converter, Bluetooth® mesh network
- Powered by DALI BUS, extremely ease of use with DALI system, especially with D4i driver.
- Mesh network, which has a much longer control distance, transmits received signals to neighboring devices
- All devices on DALI line are broadcast controlled by mobile application
- Supporting our kinetic energy switches and EnOcean switches EWSSB and EWSDb
- In typical indoor environment, the typical range for wireless communication is 20m to 25m . Actual range is dependent on field installation
- On-board antenna
- Waterproof grade: IP20
- 5 years warranty

### Parameters

Input	Power	DALI BUS
	Signal	Bluetooth
DALI Consumption	Current	Max. 20mA
Control	Dimming Curve	Logarithmic
	Dimming Method	PWM
Environment	Operating Temperature	0°C~+45°C
	Relative Humidity	8% to 80%
Others	Size	See dimensions

### Product info

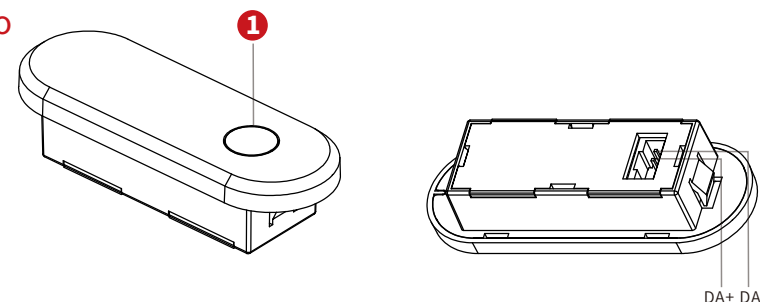

① Reset Key: Press it to help withdraw the device from internet/APP, LED flashes quickly indicates success.

**Note:** DA+/DA-: DALI signal port

### Operation

- Do wiring according to connection diagram.
- Kindly refer to “Silvair Commissioning User Manual” for further pairing.
- Press and hold down the “Reset” button on the controller over 5 seconds until the indicator flashes , which means it has been reset.





## DALI BLE Fixture-integrated Sensorless Controller

SR-SV9035A-D

### Dimension

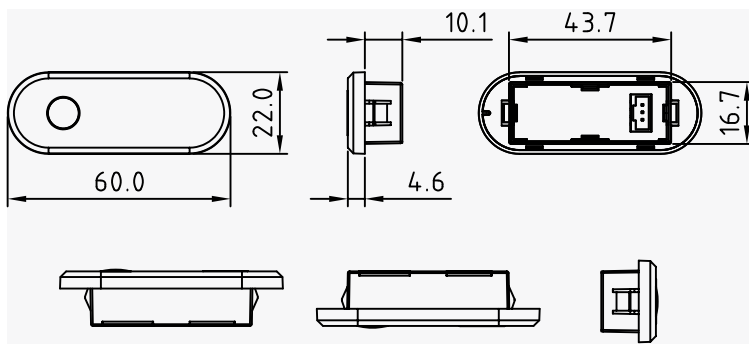

### Wiring

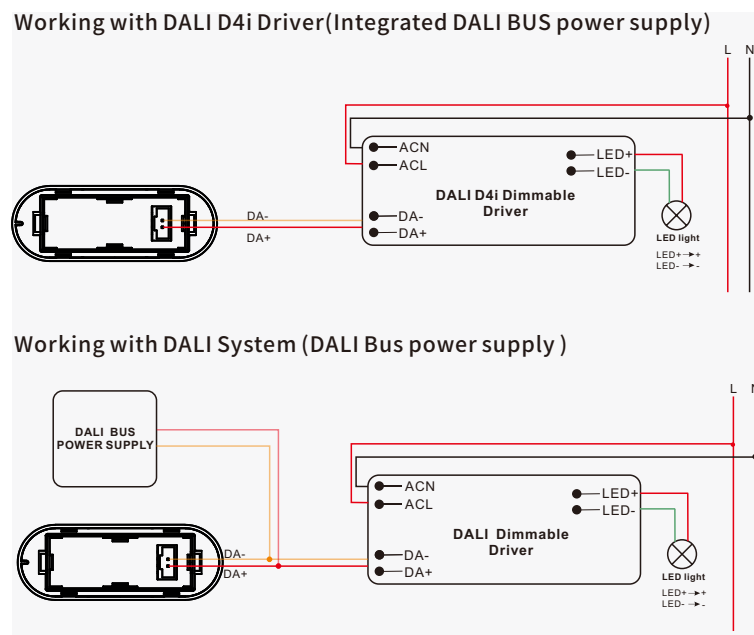

### Warning

- DO NOT install with power applied to device.
- DO NOT expose the device to moisture.

Technology Partner  
**SILVAIR**

Work with Silvair



### Application

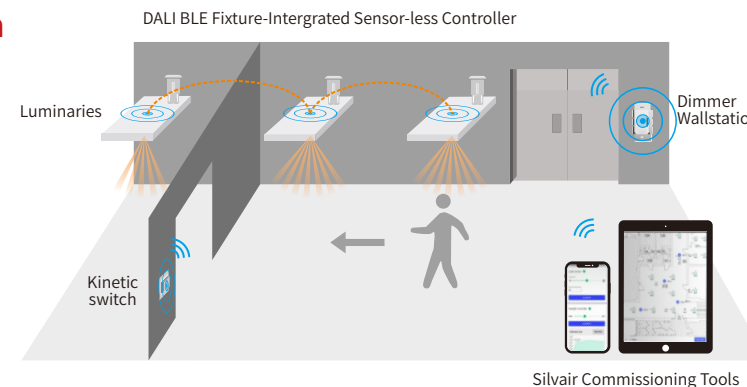

### Specification

#### COMFORT & CONVENIENCE

- Low/High-end trimming
- Manual control
- Cost-effective solution for energy savings
- Auto and advanced demand response programs
- Zone linking
- Working with kinetic switch and DALI dimmable drivers
- In-node Scheduling(INS) function

#### ENVIRONMENT & APPROBATION

- Operating temperature: 0°C to 45°C
- Agency approbations: FCC/RoHS/BQB/UL Listed...
- Warranty: 5 years

### Update Log

Date	Version	Update Content	Update by
2024-12-24	V1.0	Initial Version	Romeo

Subject to change without notice. Please contact us if you have any questions.

