



Technology Partner
SILVAIR

Work with Silvair

BLE Kinetic Push Button Switch

SR-SBP2801K4-BLE

Features

- CCT wall remote based on Bluetooth® Mesh network
- Self-powered wall remote, no battery replacement & re-installation costs
- No wires, no batteries, no limits
- Ultra long lifetime, more than 1 million times pushing
- Easy & quick pairing through APP
- Mesh network for further control distance, receivers can transmit signal to each other
- 2.4 GHz global operation
- Transmission range between every two neighbor devices up to 30m
- Standard size, compatible with existing EU size frame
- Working with our BLE driver, controller, signal converter, sensor series product
- On-board antenna
- Waterproof grade: IP20
- 5 years warranty

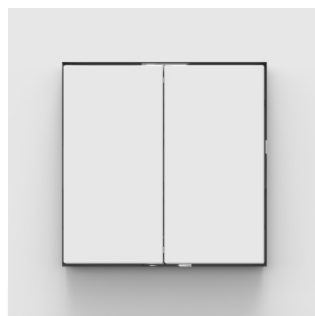

Parameters

Protocol	Bluetooth® mesh
Power Supply	Self powered by built-in nano generator
Transmission Frequency	2.4GHz
Transmission Range(free field)	Min.30m
Protection Type	IP20
Dimming Range	0.1%-100%
Dimensions	86x86x14.4mm

Product info

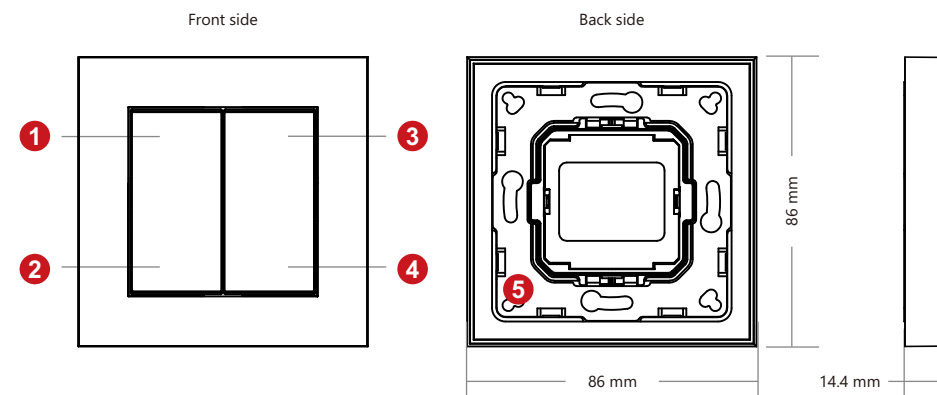

① Click to turn on, Press and hold down to increase light intensity.

② Click to turn off, Press and hold down to decrease light intensity.

③ CW button: click to recall the scene, press and hold to increase cool white.

④ WW button: click to recall the scene, press and hold to increase warm white.

⑤ The remote control can be fixed on the wall with 3M glue or screw.

NOTE: In order for switches to operate as described above, our BLE Switch Module should be mounted, and please make sure the “I” label is placed above the “O” label.





BLE Kinetic Push Button Switch

SR-SBP2801K4-BLE

Technology Partner
SILVAIR Work with Silvoir



Installation

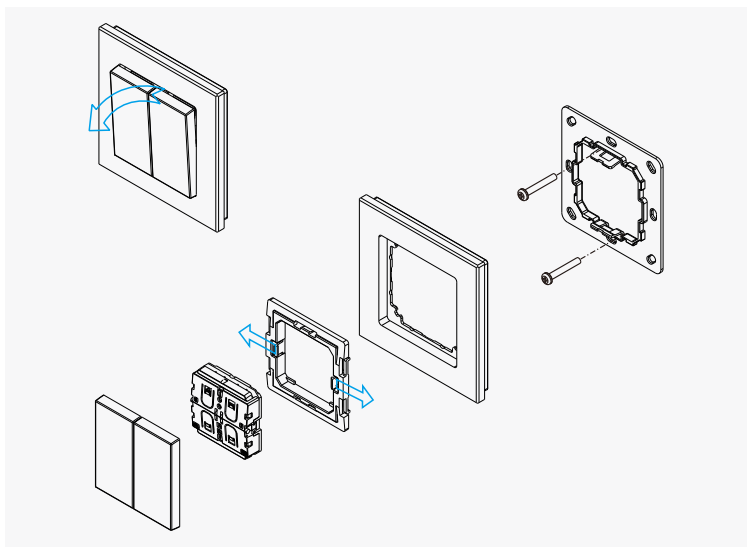

Warning

- DO NOT expose the device to moisture.

Operation

- Kindly refer “Silvoir Commissioning User Manual” for further pairing, grouping, scene settings.
- Kindly refer “Silvoir Kinetic Switch Keypad User Manual” to go further pairing, grouping, scene settings.
- Press and hold down the “Reset” button on the controller over 5 seconds until the indicator flashes , which means it has been reset.

Application

