

Casambi Wireless IP65 ZHAGA-BOOK 18 DALI-2 Sensorless Controller

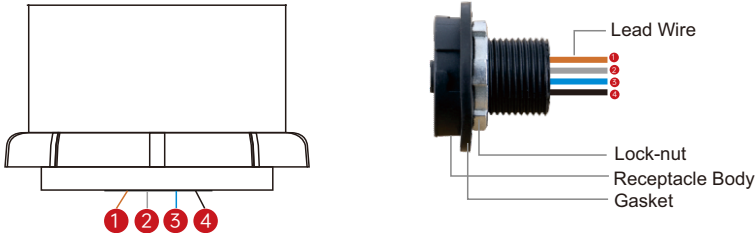

Important: Read All Instructions Prior to Installation

Function introduction



Zhaga Receptacle Accessory(optional for order)

- 1 Port 1 (Brown): No Connection
- 2 Port 2 (Gray): GND/ DA- (DALI signal)
- 3 Port 3 (Blue): DA+ (DALI signal)
- 4 Port 4 (Black): No connection

Product Description

The IP65 sensorless DALI controller combines DALI dimming and Casambi radio technology. When used with DALI LED drivers, it enables any lighting manufacturer to deliver wirelessly-controllable and DALI-enabled fixtures with minimal engineering effort. The DALI-enabled luminaires just need to be connected to mains power. The result is increased occupant comfort and significant energy savings that meet the most demanding building energy codes.

Casambi Technology Explained

The Casambi technology provides a mesh network where all the intelligence of the system is replicated in every node and, in such a way, creates a system with no single point of failure. In this kind of fully distributed architecture, any unit can go offline and catch up from others when they return back online.

Wireless Features

- Control a large number of fixtures from any point
- Simple to use UI
- Wide range of functionality – Grouping Luminaires, different lighting situations for different occasions, colour temperature, and much more.

Key Features

- Works with DALI-2 D4i drivers or non-D4i drivers, broadcast control
- Zhaga Book 18 socket
- Can be used for outdoor applications

Benefits

- Cost-effective solution for energy savings
- Energy code compliance
- Robust mesh network

Applications

- Warehouses
- Factories
- Street and Area Lighting
- Outdoor Luminaires - Wall Packs - Parking Lots - Walkways
- Photo Controls
- Central Management System

Product Data

Electrical Information

Power Supply	DALI BUS
Power Consumption	Max. 20mA
Control	DALI-2
Marking Terminals	DA-, DA+

Wireless Communication

Transceiver Frequency	2.4GHz ISM band
Radio Range	164 feet (50m) in open field
Radio Certification	FCC/IC, CE

Lighting Control

Features	DALI broadcast, Individual/group addressing, Scene control Scheduler control
----------	---

Environment

Operating Temperature Range	0°C to 40°C
Operating Humidity	0-95% (non condensing)
Safety Certification	cULus Listed, CE

Wiring Diagram

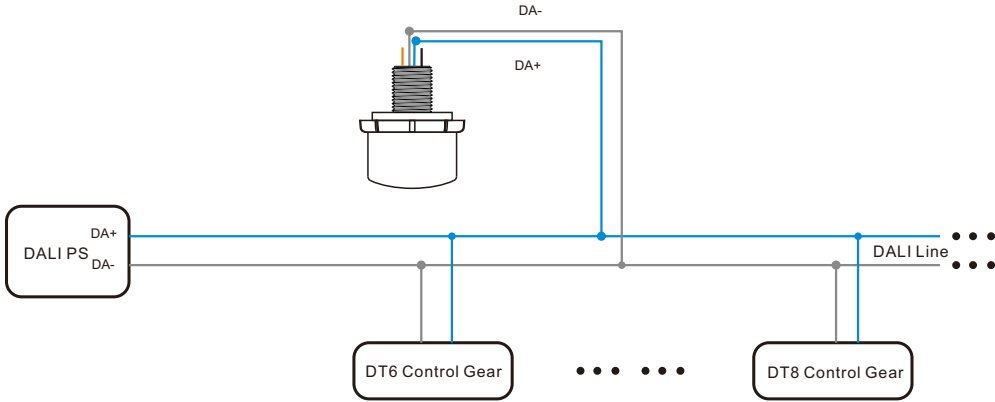

Note: please make sure the polarity of DALI signal of the sensor is correctly connected.

Product Dimension

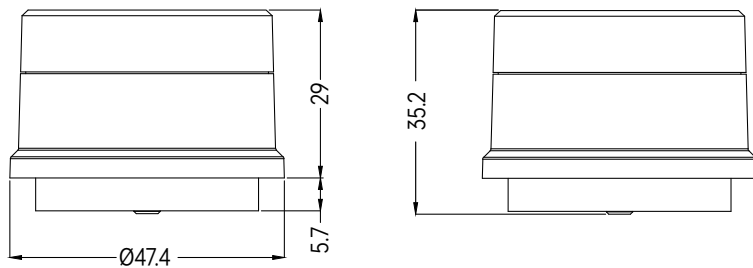

Operation

Select Profile:

Factory default profile of this device is DALI DIM Broadcast, you can select a profile through the operation of “Change profile”.

Power on the device, make sure the device is unpaired, open Casambi app, navigate to “Nearby devices”, the device will be displayed, double click the device, then choose “Change profile” from the pop up menus, then select a profile as shown in following figures.

