

RF Dual Color Wall Mounted Controller

09.280BU.04185



Important: Read All Instructions Prior to Installation

Function introduction

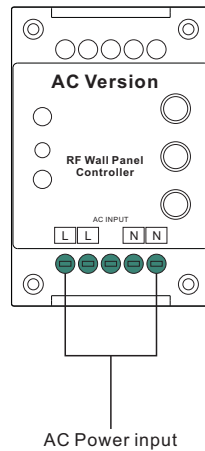
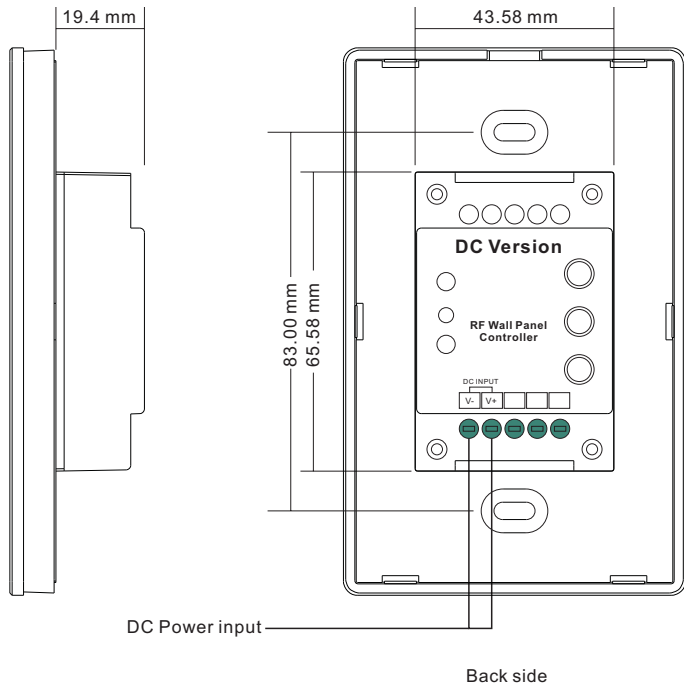
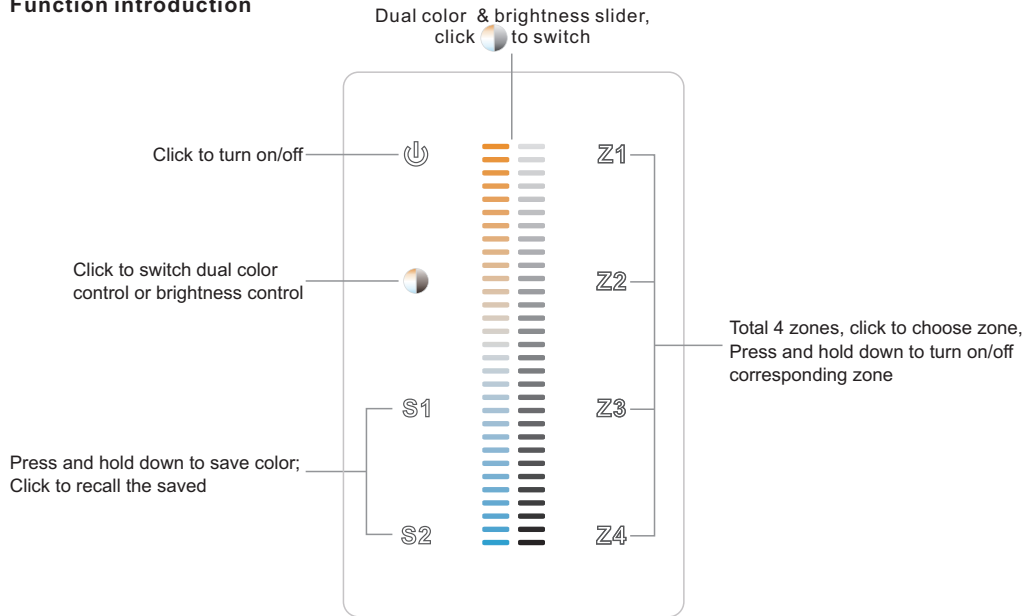

Product Data

	DC Version	AC Version
Output Signal	RF signal	RF signal
Power Supply	12-24VDC	100-240VAC
Power consumption	20 mA	20 mA
Operating temperature	0-40°C	0-40°C
Relative humidity	8% to 80%	8% to 80%
Dimensions	75x120x29.1mm	75x120x29.1mm

- Touch sensitive
- Glass interface(white & black)
- Compatible with all universal series RF receivers, radio frequency: 916.5MHz
- Control CCT color
- Control 4 zones synchronously and separately
- Waterproof grade: IP20

Safety & Warnings

- DO NOT install with power applied to device.
- DO NOT expose the device to moisture.

Wiring diagram

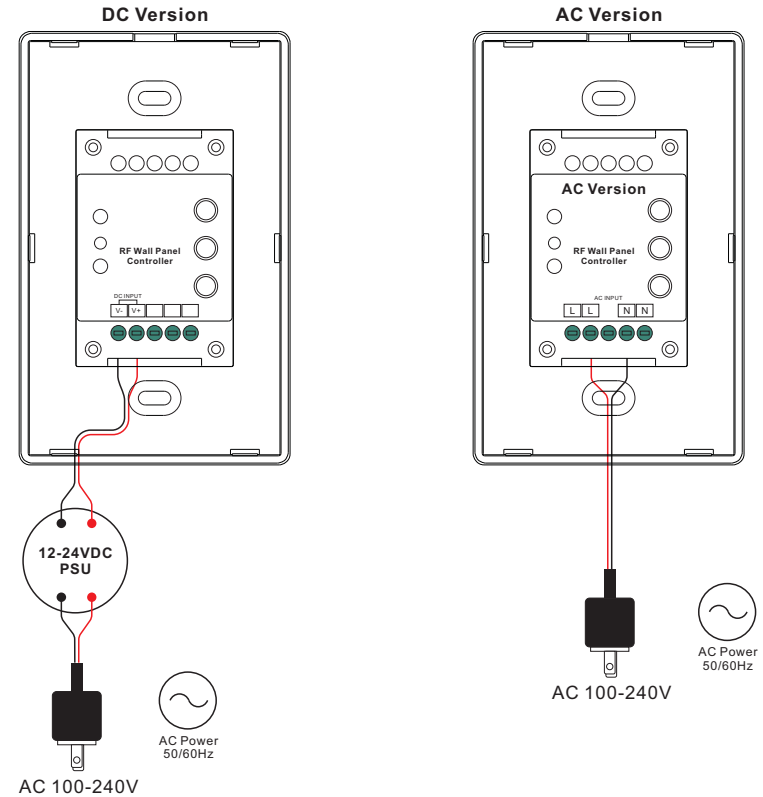

Operation

1. Do wiring the wall panel & RF receiver according to wiring diagram (please refer to the instruction of RF receiver that you would like to pair with)
2. Power on, then touch the button  to turn on the controller, indicator of the controller turned blue

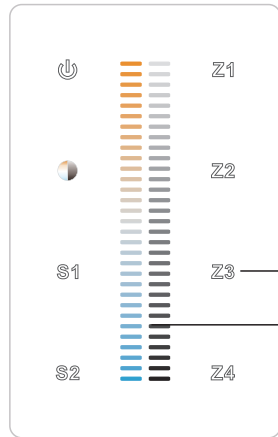

Pair with RF receiver



Step 1: Click the "Learning Key" button on RF receiver or re-power on the receiver three times continuously to set it into pairing status

Step 2: Choose and click a zone number (e.g. zone 3)

Step 3: Touch the slider, LED lights connected with the RF receiver flicker once means the receiver is paired with zone 4 successfully.

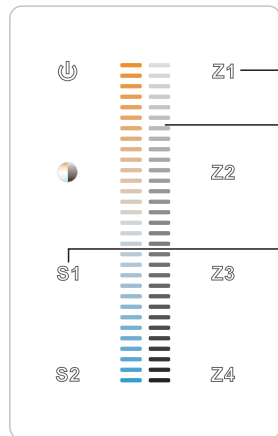

Save color/scene/mode

Step 1: Choose and click one or multiple paired zone numbers (e.g. zone 1)

Step 2: Touch the slider to select the scene you like

Step 3: Press and hold any scene buttons of S1/S2 (e.g. S1), LED lights connected with the RF receiver flicker once means the color/scene was saved successfully.

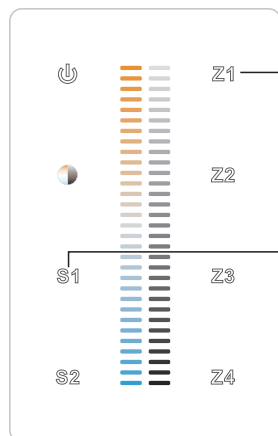

Recall the saved colors/scenes

Step 1: Choose and click one or multiple paired zone numbers (e.g. zone 1)

Step 2: Click any scene buttons of S1/S2 (e.g. S1) to recall the saved scene

Installation

