

DALI 2PIN DT8 CCT LED Dimmer

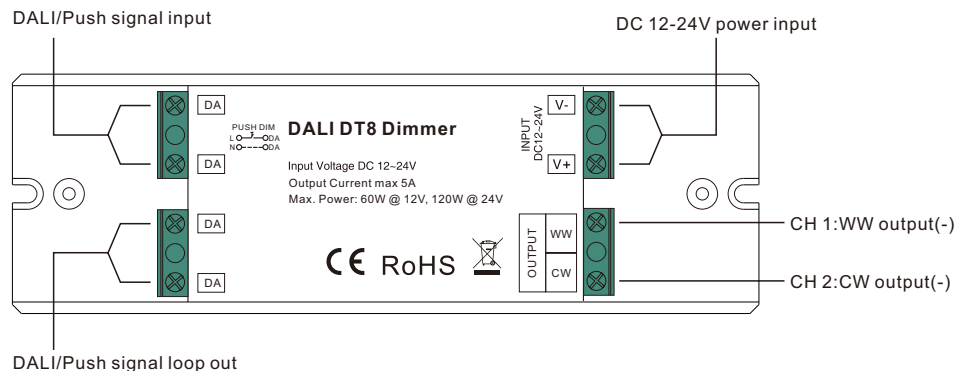

Important: Read All Instructions Prior to Installation

Function introduction



Product Data

Input Voltage	Output Current	Output Power	Remarks	Size(LxWxH)	DALI Consumption	Dimming Range	Ambient Temperature
12-24VDC	5A	60-120W	Constant voltage	145x46.5x16mm	2mA	0.1%-100%	-20°C ~ +50°C

- In compliance with IEC 62386-101:2014, IEC 62386-102:2014, IEC 62386-207 Ed2, IEC 62386-209:2011
- Built-in DALI-2 interface, DALI DT8 device
- DALI DT8 device to control Warm White and Cool White output via a single DALI address
- 2 Pin CCT output, suitable for cabinet and furniture lighting control
- Enables Dimming and Color Temperature Adjustment
- Color control as defined in the DALI specification for device type 8, color type Tc.
- Supports DT8 device commands, compatible with DALI masters that support DT8 commands
- Compatible with universal standard DALI-2 systems
- Waterproof grade: IP20

Safety & Warnings

- DO NOT install with power applied to device.
- DO NOT expose the device to moisture.

Operation

1. DALI Address Assignment

DALI address is assigned by DALI Master controller automatically, please refer to user manuals of compatible DALI Masters for specific operations.

2. Push Dimmer Mode

While connected with a AC push switch, the device will be controlled through Push Dimmer Mode, operations under Push Dimmer Mode are as follows:

- 2.1. Click the button to switch ON/OFF
- 2.2. Press and hold down the button to increase or decrease light intensity to desired level and release it, then repeat the operation to adjust light intensity to opposite direction. The dimming range is from 1% to 100%.
- 2.3. Double click the button to switch between brightness mode and color temperature mode.
- 2.4. Press and hold down the button to change color temperature under color temperature mode.
- 2.5. Memory function after power off or power failure enables the device to memorize the status before power off while power on again.

Wiring diagram

1. With DALI Bus

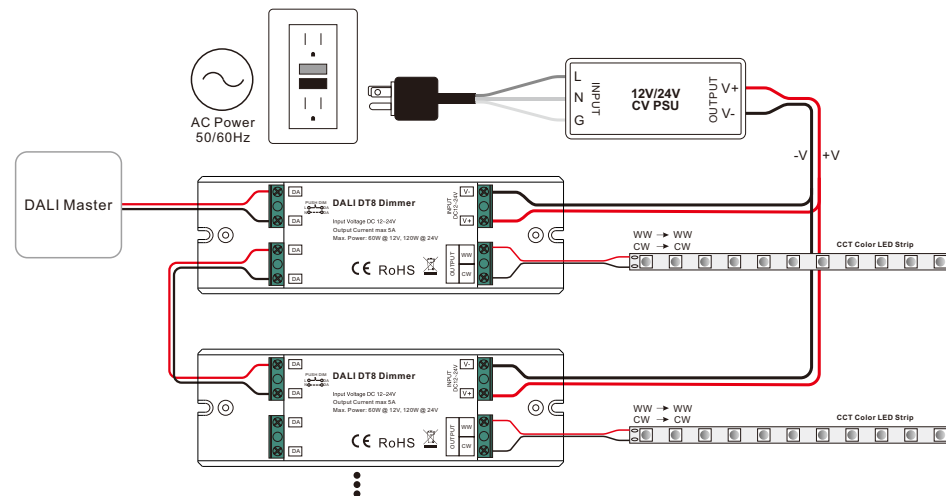

2. With Push Dimmer

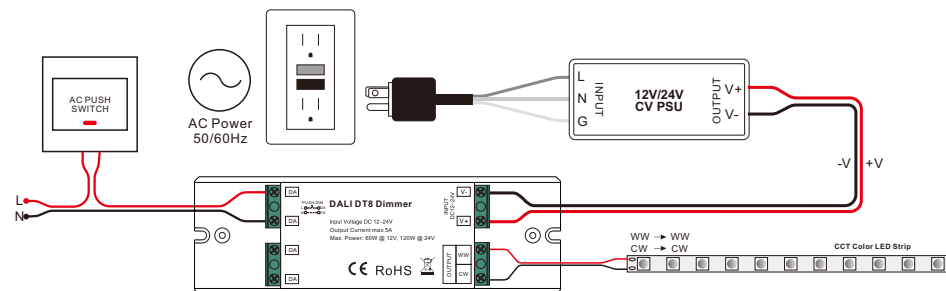

Product Dimension

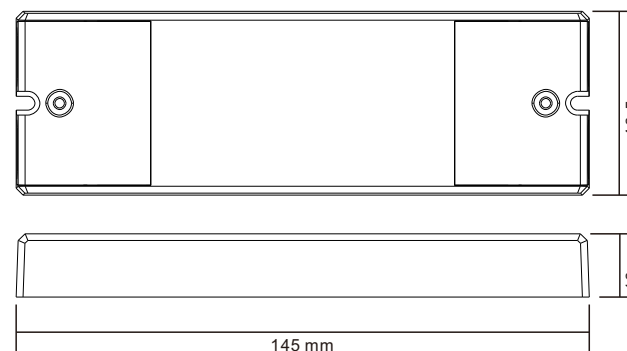

Conformity & Standards

- Radio Frequency Interference according to EN 55015:2013/A1:2015
- Immunity standard according to EN 61547:2009
- TÜV SÜD marked, CE marked